

23M160

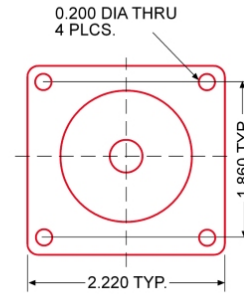
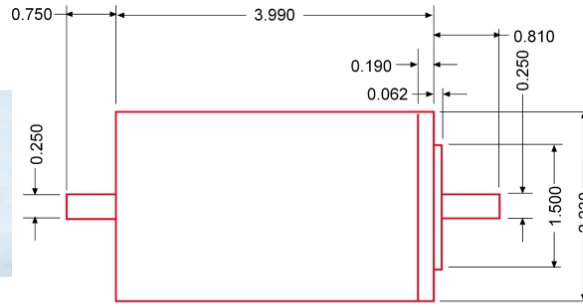

SPECIFICATIONS:

Holding Torque..... 160 oz-in
 Rotor Inertia..... 1.72 oz-in²
 Step Angle..... 1.8 deg.
 Weight..... 2.8 lbs

MOTOR POWER CONNECTORS:

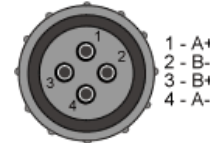
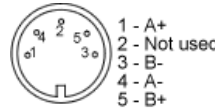

	Parallel	Series	Half Coil
Resistance	.82 ohms	3.26 ohms	1.63 ohms
Rated Current	3.49 amps	1.75 amps	2.47 amps
Rated Voltage	2.83 volts	5.66 volts	4.0 volts
Inductance	4.2 mH	16.8 mH	4.2 mH

5 pin female DIN connector-front view
 4 pin female circular connector-front view
 cable length-10' standard

WIRING CONFIGURATIONS:

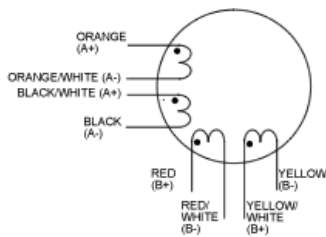

8 lead parallel (standard)

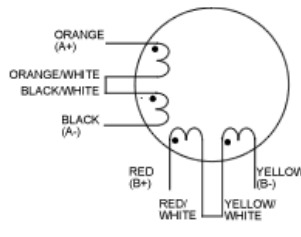

8 lead series

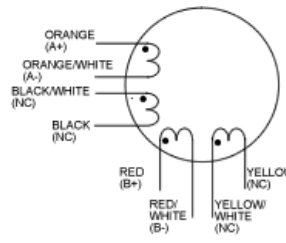

8 lead half coil

Torque Curves

